

GENERAL DESCRIPTION

- ✓ 4/2- way directional control valves with mechanical operation
- ✓ Reliability and long life
- ✓ Mounting surface CETOP3 (NG6)

RH06...4F...



Symbol



These RH06...4F... valves consist of a spool , housing , springs and mechanical control unit. They used to control the start , stop and direction of flow.

The valves are used for hydraulic power control. This model is designed with two-spring centered spool.

The housing has 5-chambers and vertical "T" duct.

The valve location during assembly is of minor importance , but the horizontal position is generally recommended.

ORDERING CODE

See page 8/17.

FUNCTIONAL SYMBOLS

See page 3/17.

TECHNICAL DATA

| DATA | UNIT | VALUE/RANGE |
|-----------------|---------------------------------|-------------|
| Weight | kg | 1,420 |
| Max. Pressure | port P , A & B port T | 32 16 |
| Rated flow | (at $\Delta p=0,1\text{MPa.}$) | l/min |
| Actuating force | $-F_{\min}$ $-F_{\max}$ | 30 130 |

CHARACTERISTICS

See page 6/17



DIMENSIONS

All dimensions are shown in mm.

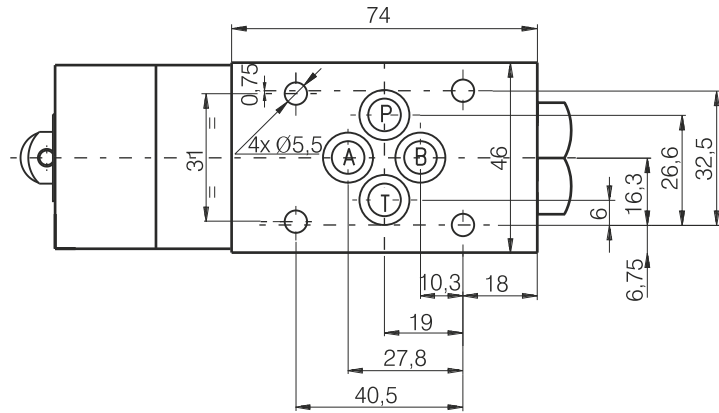

Symbols 12 , 17 , 24 , 27 , 34 , 39 , 45 , 68 , 70 , 83

Symbols 10 , 13 , 16 , 28 , 32 , 36 , 64 , 78

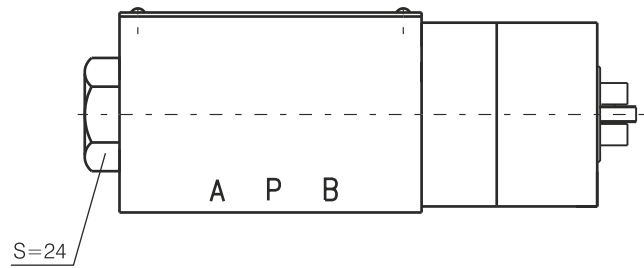
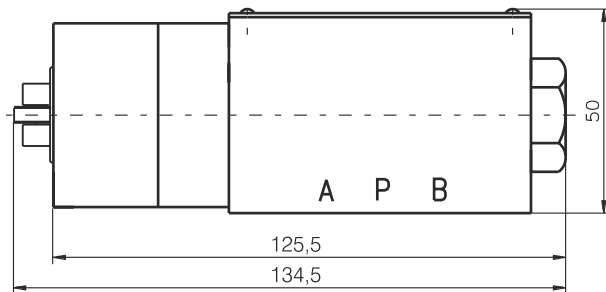

SEALS

